



Umbrella Tool Changer - 810/820 Cable - Replacement

Scan code to get the latest version of this document



Translation Available



VMC - Umbrella Tool Changer - 810/820 Cable - Replacement

This procedure tells you how to replace the 810/820 cable for the umbrella tool changer.

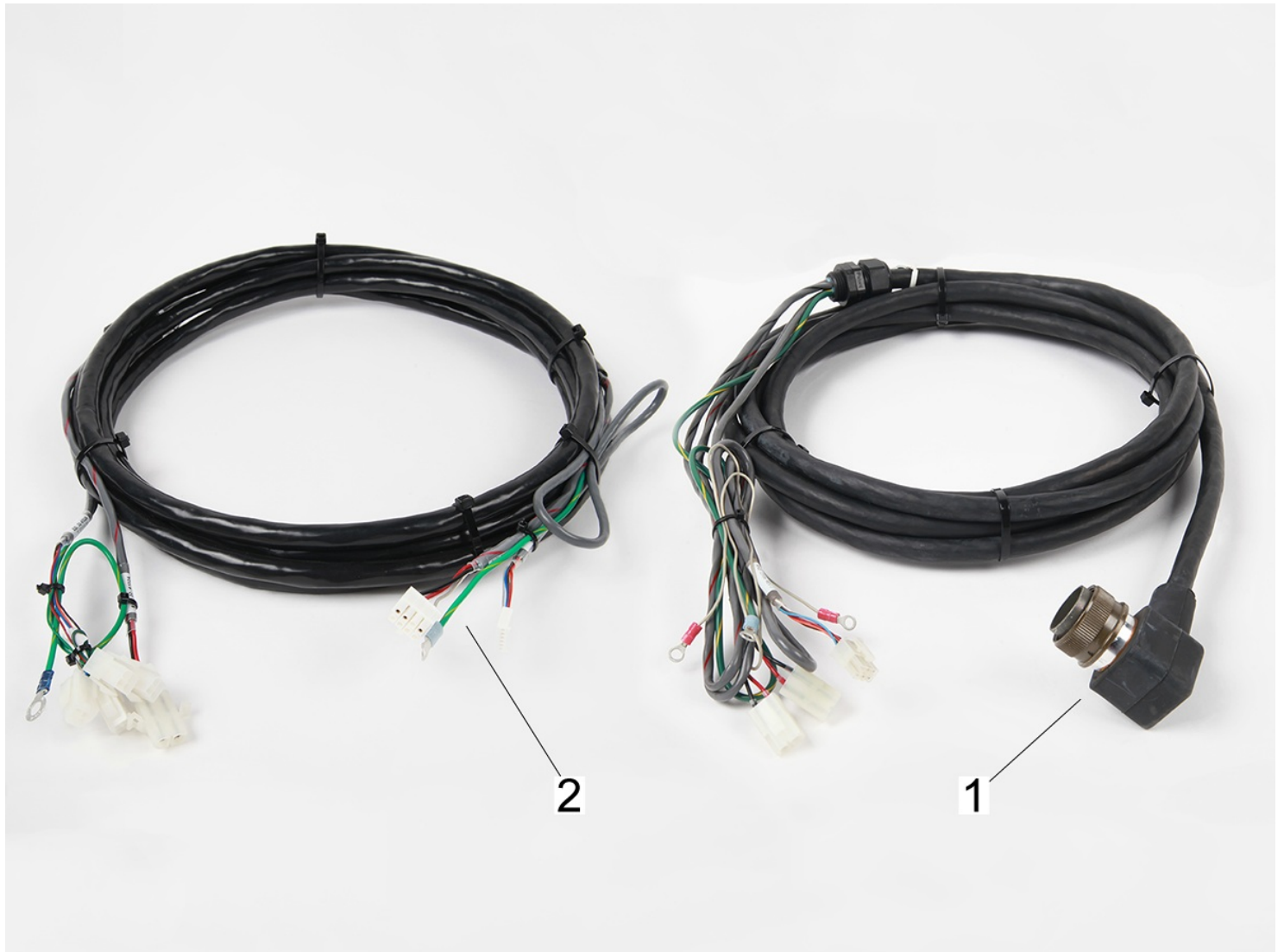

This procedure tells you how to replace these two types umbrella tool changer 810/820 cables:

- Cables with amphenol connectors [1] that attach to the side of the control cabinet. These types of cables connect to the amphenol connector and go to the umbrella tool changer assembly.
- Cables without an amphenol connector [2] go through the top of the control cabinet and connect from the umbrella tool changer assembly directly to the I/O PCB.

Prerequisites

This procedure is applicable to more than one kit. Only one of the kits in the **Parts Included** section is necessary.

Parts Included



32-4132A QTY: 1
CABLE, UMBRELLA, 810/820 I/O TO
ARM, 17.5 FT



32-7061 QTY: 1
CABLE, UMBRELLA, 810/820 I/O TO
ARM, 12.5 FT



32-7063 QTY: 1
CABLE, UMBRELLA, 810/820 I/O TO
ARM, 39.0 FT (GR-510/512/712)



32-7066 QTY: 1
CABLE, UMBRELLA, 810/820 I/O TO
ARM, 18.5 FT



32-7080 QTY: 1
CABLE, UMBRELLA, 810/820 I/O TO
ARM, 16.5 FT



32-7011A QTY: 1
CABLE, UMBRELLA, 810/820
AMPHENOL TO ARM 14.3 FT



32-7012B QTY: 1
CABLE, UMBRELLA, 810/820
AMPHENOL TO ARM, 18.8 FT



32-7018 QTY: 1
CABLE, UMBRELLA, 810/820
AMPHENOL TO ARM, 40.8 FT

STEP 1



Push **[POWER OFF]**. Set the main circuit breaker to the **OFF** position. Lock the main circuit breaker. Use an approved lock with an approved safety tag.



Danger: After turning off the machine, wait at least 5 minutes before working in the control cabinet, to allow power to dissipate. Wait for the voltage indicator LED on the vector drive to go off completely.

Some service procedures can be dangerous or life-threatening. DO NOT attempt a procedure that you do not fully understand. If you have any doubts about doing a procedure contact your Haas Factory Outlet (HFO) and schedule a service visit.

STEP 2

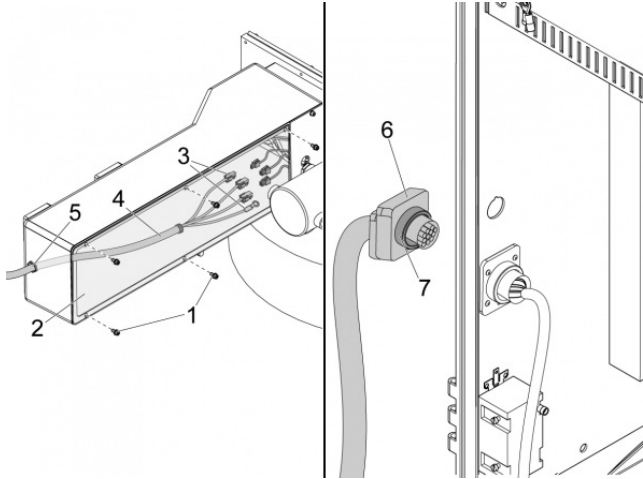

Do this step to replace a cable that has an amphenol connector.

Remove the screws [1] and cover [2] for the support arm of the tool changer. Disconnect the 810 and 820 cable connections and the ground wire [3].

Remove the nut [5] and cable [4].

Turn the nut [7] on the amphenol connector [6] on the side of the control cabinet.

Install the new amphenol connector [6]. Turn the nut [7] on the new amphenol connector [6] to install it onto the control cabinet.

Connect the new 810/820 cable [4] in the same position as the removed 810/820 cable. Use the nut [5] to attach the new 810/820 cable. Connect the 810 and 820 cable connections and the ground wire [3].

Install the screws [1] and the cover [2] for the support arm.

STEP 3

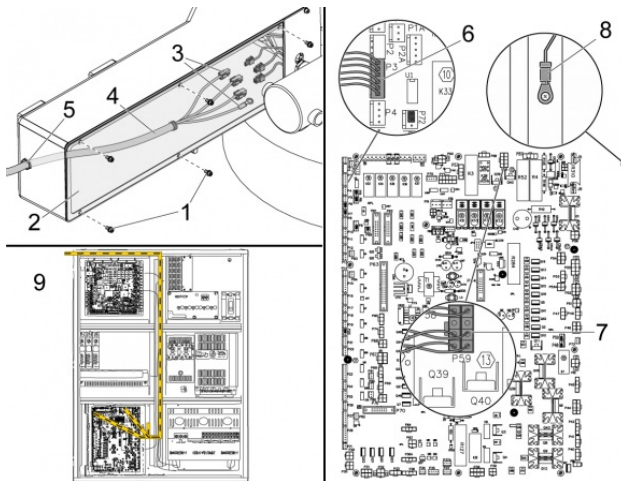

Do this step to replace a cable that does not have an amphenol connector.

Remove the screws [1] and the cover [2] for the support arm of the tool changer. Disconnect the cables and ground wire [3] from the 810/820 cable [4]. Remove the nut [5] and cable [4].

Disconnect these connections from the control cabinet:

- ground cable [8] from the right side of the I/O PCB
- 810 connection to P59 [7] on the I/O PCB
- 820 connection to P3 [6] on the I/O PCB

Connect the new 810/820 cable to the same positions on the I/O PCB. Put the new 810/820 cable through the cable channel [9].

Use the nut [5] to attach the new 810/820 cable [4] to the support arm. Connect the 810 and 820 cables and the ground wire [3] from the cable [4] in the support arm.

Install the screws [1] and the cover [2] for the support arm.