



SL Lathe - Parker Hydraulic Power Unit - Filter - Replacement

Scan code to get the latest version of this document



Translation Available



SL Lathe - Parker Hydraulic Power Unit - Filter - Replacement - Introduction

Do this procedure to prevent these problems:

1. contamination in the hydraulic fluid
2. incorrect flow in the pump
3. low pressure in the pump.

Each of these problems causes damage to the Hydraulic Power Unit (HPU). Do this procedure at intervals of 5,000 hours. Or do this procedure if you have one of these conditions:

1. The tailstock or chuck moves slowly.
2. Alarm 134 LOW HYDRAULIC PRESSURE occurs.

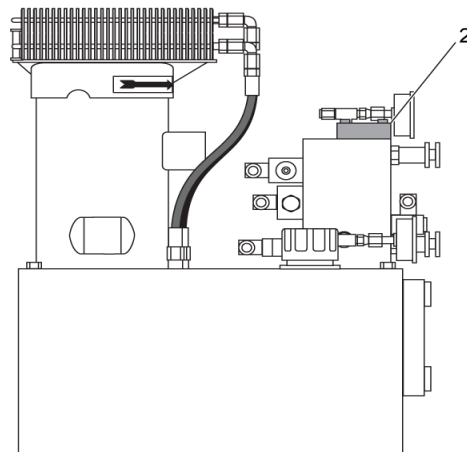
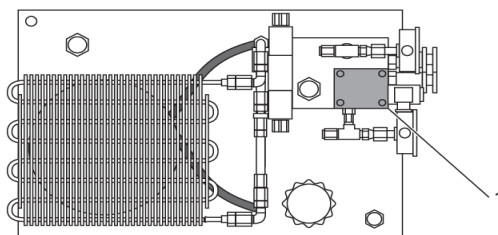
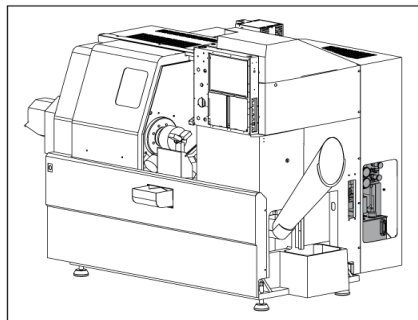

- Parker HPU Oil Filter [1] (Top View)
- Parker HPU Oil Filter [2] (Side View)

 **Caution:** When you do maintenance or repair on CNC machines and their components, you must always follow basic safety precautions. This decreases the risk of injury and mechanical damage.

Do these steps before you do work in the machine or in the control cabinet:

- Set the main circuit breaker to the **[OFF]** position.
- Use an approved lock with an approved safety tag. Always follow lock-out procedures in accordance to local government rules.
- After turning off the machine, wait at least 5 minutes before working in the control cabinet, to allow power to dissipate. Wait for the voltage indicator LED on the vector drive to go off completely.
- Always turn off the main air supply when you work on any part of the pneumatic system.
- Make sure to rest the spindle head on a block of wood when work is done on a vertical axis. This will prevent any unintended movement that could result in the axis falling.
- Never alter any safety circuits on the machine.

You should not do machine repair or service procedures unless you are qualified and knowledgeable about the processes. Serious damage to the machine components can result in costly repairs. The service technicians at your Haas Factory Outlet (HFO) have the training and experience, and are certified to do these tasks safely and correctly. The repair and service work performed by your HFO is protected with a limited warranty.

 **Danger:** Some service procedures can be dangerous or life-threatening. DO NOT attempt a procedure that you do not fully understand. If you have any doubts about doing a procedure contact your Haas Factory Outlet (HFO) and schedule a service visit.

Prerequisites

Refer to [SL/ST Lathe - Maximum Chuck Operating Pressures](#) to make sure you have the correct hydraulic pressure.

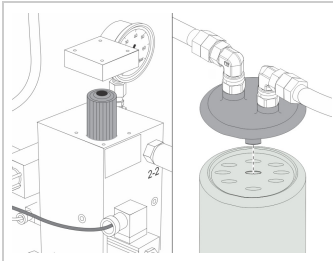

The Parker HPU can have (2) different filter configurations:

- A filter inside the valve block
- A filter canister with a fitted lid

Look for the manufacturer's label on the HPU filter cover to see which filter element you need. Refer to the **Parts Included** list to see which filter element or canister you need to order.

Machine Compatibility

Do this procedure only for a Parker HPU. ST lathes can have only a Haas HPU. SL lathes can have a Parker HPU and also these types:

- Haas HPU, refer to [Haas Hydraulic Power Unit - Filter - Replacement](#).
- Rexroth HPU, refer to [SL Lathe - Rexroth Hydraulic Power Unit - Filter - Replacement](#).

Parts Included



58-6034 QTY: 1
FILTER, ELEMENT 10 MICRON
HYDAC/PARKER (HAAS/PARKER
HPU)



58-6035 QTY: 1
FILTER, CANISTER 10 MICRON
PARKER W/ HEAD (PARKER HPU)



93-0158 QTY: 1
FILTER, CANISTER 10 MICRON
VESCOR (PARKER HPU)



93-9123 QTY: 1
FILTER, CANISTER 10 MICRON
PARKER (PARKER HPU)

SL Lathe - Parker Hydraulic Power Unit - Filter - Replacement

STEP 1



Push **[POWER OFF]**. Set the main circuit breaker to the **OFF** position. Lock the main circuit breaker. Use an approved lock with an approved safety tag.

STEP 2

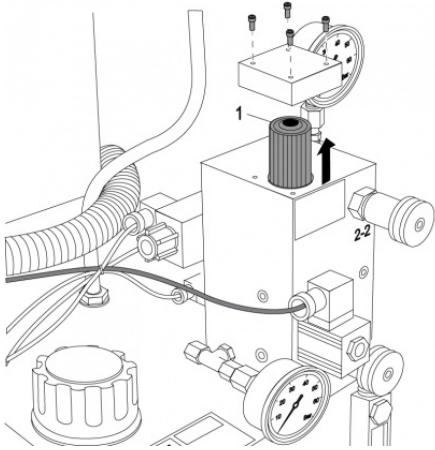

Do this step to replace a filter element in a valve block.

Remove the (4) screws and the filter cover plate on the top of the valve block.

Replace the oil filter [1].

Install the filter cover plate with the (4) screws.

STEP 3

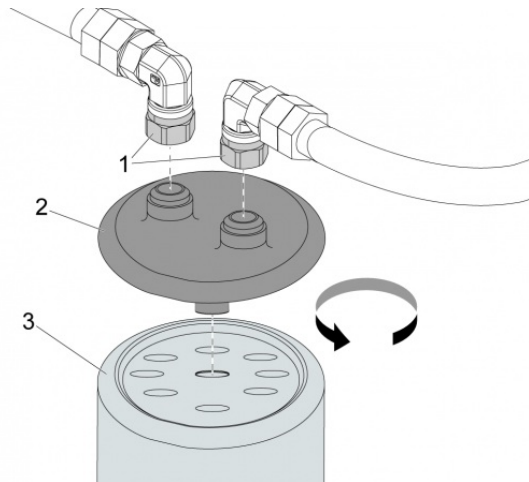

Do this step if you have a canister filter setup.

To replace the entire canister, do these steps:

1. Loosen the fittings [1] on the HPU assembly.
2. Remove the canister [2 and 3].

To replace the filter element, do these steps:

1. Turn the filter element [3] counter clockwise to remove it from the canister lid.
2. Install the new filter element [3] onto the canister lid.

STEP 4



Set the main circuit breaker to the **ON** position. Push **[POWER ON]**.



Push **[RESET]** two times to activate the HPU. Make sure the HPU operates correctly and has no leaks. Push **[ZERO RETURN]**. Push **[ALL]**.

Operate the hydraulic components. Make sure they have no leaks. Make sure the pressure is correct. Make sure the fluid level in the HPU tank is correct.

