



Front Window - VF-3/4/5/6/8 - Replacement

Scan code to get
the latest version
of this document



Translation
Available

VF-3/4/5/6/8 - Front Window - Replacement - Introduction

Do this procedure to replace safety glass windows.

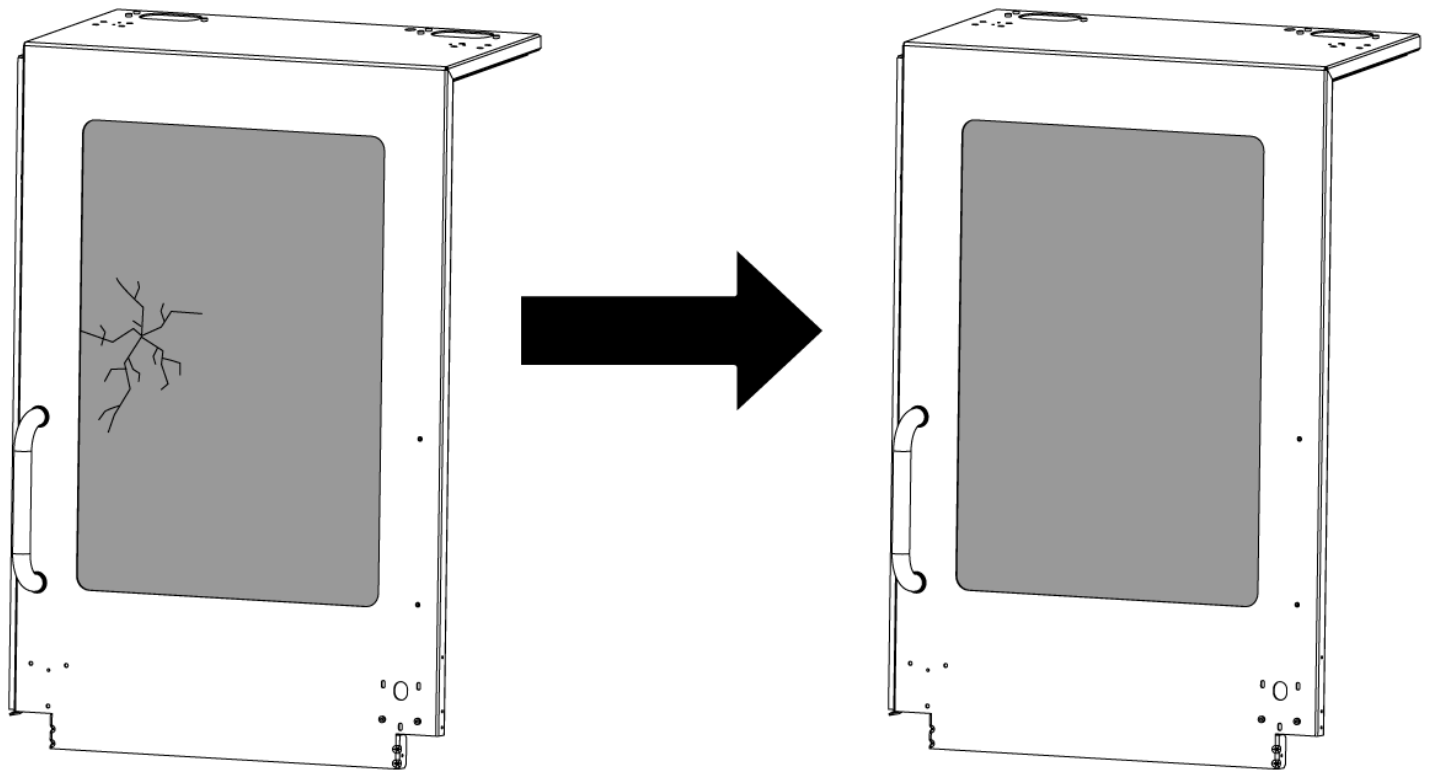

 **Caution:** When you do maintenance or repair on CNC machines and their components, you must always follow basic safety precautions. This decreases the risk of injury and mechanical damage.

Do these steps before you do work in the machine or in the control cabinet:

- Set the main circuit breaker to the **[OFF]** position.
- Use an approved lock with an approved safety tag. Always follow lock-out procedures in accordance to local government rules.
- After turning off the machine, wait at least 5 minutes before working in the control cabinet, to allow power to dissipate. Wait for the voltage indicator LED on the vector drive to go off completely.
- Always turn off the main air supply when you work on any part of the pneumatic system.
- Make sure to rest the spindle head on a block of wood when work is done on a vertical axis. This will prevent any unintended movement that could result in the axis falling.
- Never alter any safety circuits on the machine.

You should not do machine repair or service procedures unless you are qualified and knowledgeable about the processes. Serious damage to the machine components can result in costly repairs. The service technicians at your Haas Factory Outlet (HFO) have the training and experience, and are certified to do these tasks safely and correctly. The repair and service work performed by your HFO is protected with a limited warranty.

 **Danger:** Some service procedures can be dangerous or life-threatening. DO NOT attempt a procedure that you do not fully understand. If you have any doubts about doing a procedure contact your Haas Factory Outlet (HFO) and schedule a service visit.

Machine Compatibility

Do this procedure for these machines:

- VF-3/4/5/6/8

Parts Included

KIT PN: 93-2223, WINDOW, GLASS 39.25" X 29" KIT. QTY: 1



[A] 28-0139 QTY: 1
WINDOW, GLASS 39.25" X 29.0"

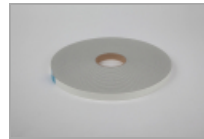

[B] 57-0505 QTY: 1 UOM: 274"
SEAL, 0.75" X 0.1875" FOAM TAPE
VINYL

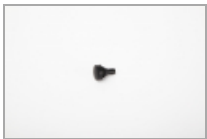

[C] 59-0786 QTY: 14
BUMPER, NITRILE .50 DIAMETER X
.25

VF-3/4/5/6/8 - Front Window - Replacement

STEP 1



Push **[POWER OFF]**.

Set the main circuit breaker to the **OFF** position.

Lock the main circuit breaker. Use an approved lock with an approved safety tag.

STEP 2

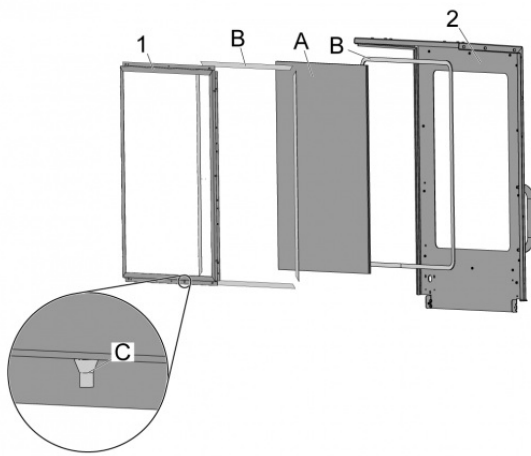

Go into the machine to get access to the inner side of the front door.

Remove the handle from the door [2].

Carefully remove the (4) retainers [1], the old bumpers [C], the old foam tape [B], and the old glass window [A].

Use a scraper to fully remove all of the old foam tape [B] from the door. Clean the areas of all remaining tape.

Cut (1) piece of the new FOAM TAPE [B] to go on each retainer and along the edge of the window opening. Apply the (5) pieces of tape. Make a 3/4" overlap at the ends of the (1) piece of tape on the door.

Find the engraved label "THIS SIDE OUT" on the pane of the new GLASS WINDOW [A]. This label must face the outside of the door.

Install the (14) new BUMPERS [C]. Install the bottom and left retainers [1]. Install the GLASS WINDOW [A]. Install the remaining (2) retainers [1].



Note: The kits include (4) HEX NUTS [C]. Replace damaged or missing nuts on the machine.