



# Ballscrew - Spacer - Installation

Scan code to get the latest version of this document



Translation Available



This document tells you when to install a spacer when you replace a ballscrew.

slide\_content

## 32 mm Ballscrew - Standard Anchor - Bearing - Identification

When you install a new 32 mm ballscrew into bearing P/N 51-0213A you must install a spacer. Refer to these images to identify the installed bearing.

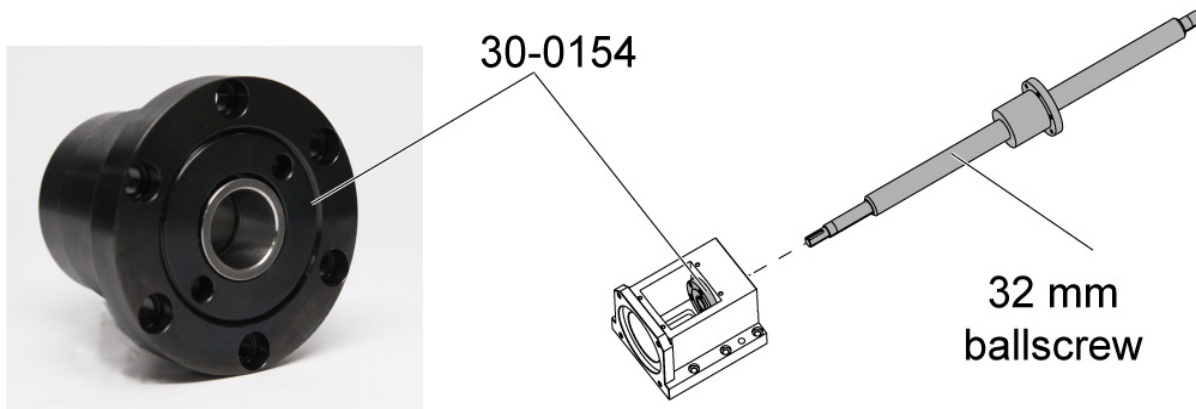

- P/N 30-0154 has a black oxide finish.
- Do not install a spacer when you install a 32 mm ballscrew into bearing P/N 30-0154.

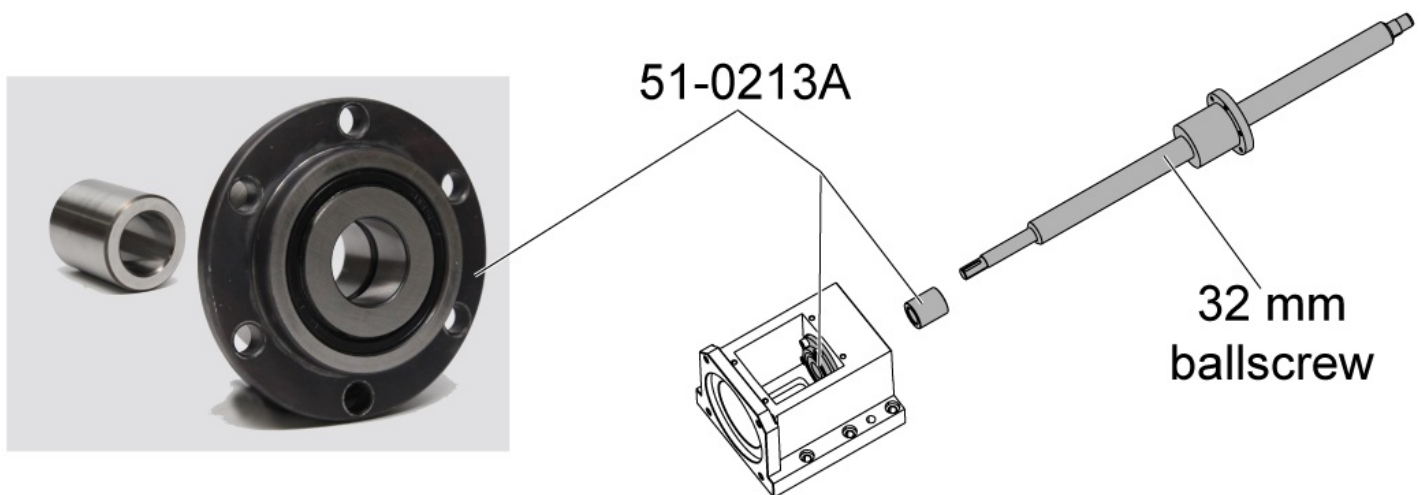

- P/N 51-0213A has a machined steel finish on the bearing. The flange is black. The spacer is included.
- Install the included spacer when you install a 32 mm ballscrew into bearing P/N 51-0213A.

slide\_content

## 32 mm Ballscrew - Reverse Anchor - Bearing - Identification

When you install a new 32 mm ballscrew into bearing P/N 51-0213A you must install a spacer. Refer to these images to identify the installed bearing.

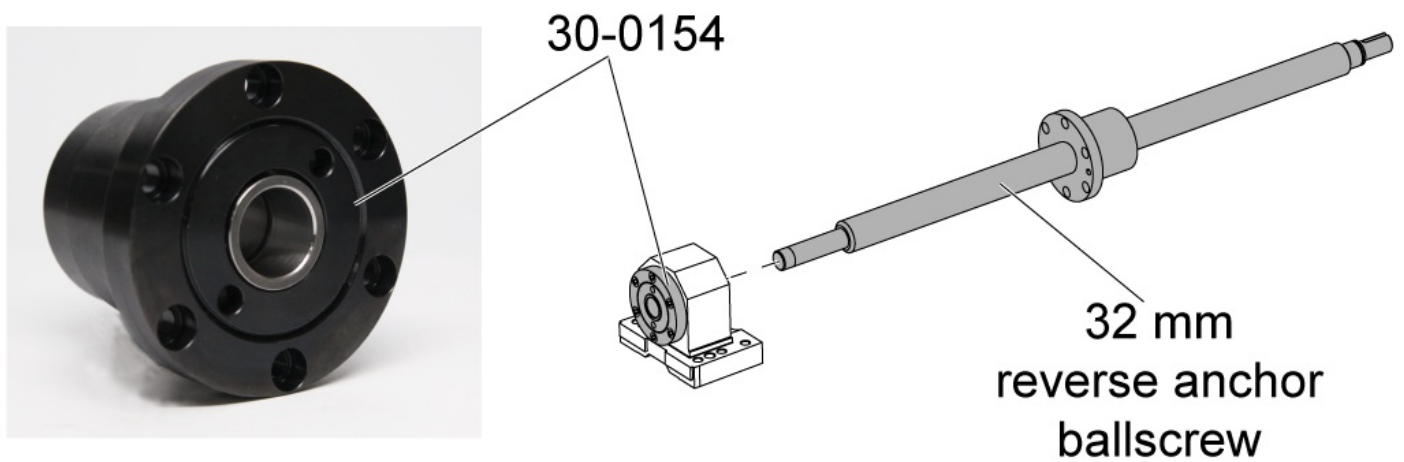

- P/N 30-0154 has a black oxide finish.
- Do not install a spacer when you install a 32 mm ballscrew into bearing pack P/N 30-0154.

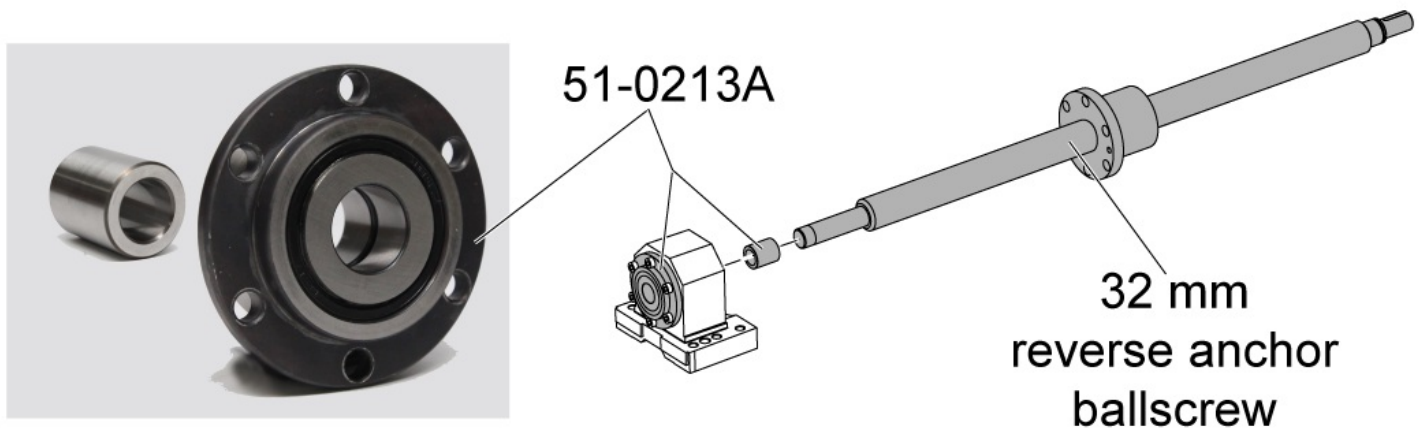

- P/N 51-0213A has a machined steel finish on the bearing. The flange is black. The spacer is included.
- Install the included spacer when you install a 32 mm ballscrew into bearing P/N 51-0213A.

slide\_content

## 40/50 mm Ballscrew - Standard Anchor - Bearing - Identification

When you install a new 40/50 mm ballscrew into bearing pack P/N 30-1222 you must install a spacer. Refer to these images to identify the installed bearing.

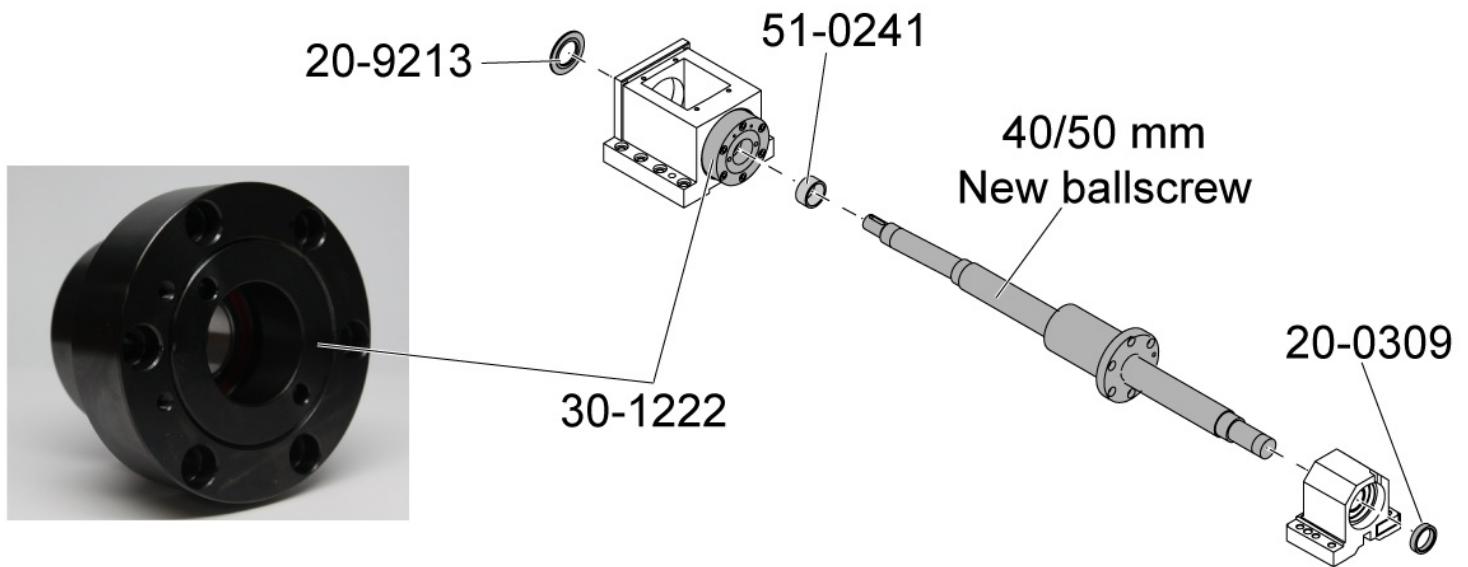

- P/N 30-1222 has a black oxide finish.
- Install spacer P/N 51-0241 when you install a new 40/50 mm ballscrew into bearing pack P/N 30-1222.
- Install spacer P/N 20-9213 in the same position on the motor end.
- Install only (1) of the spacers P/N 20-0309 on the support end.

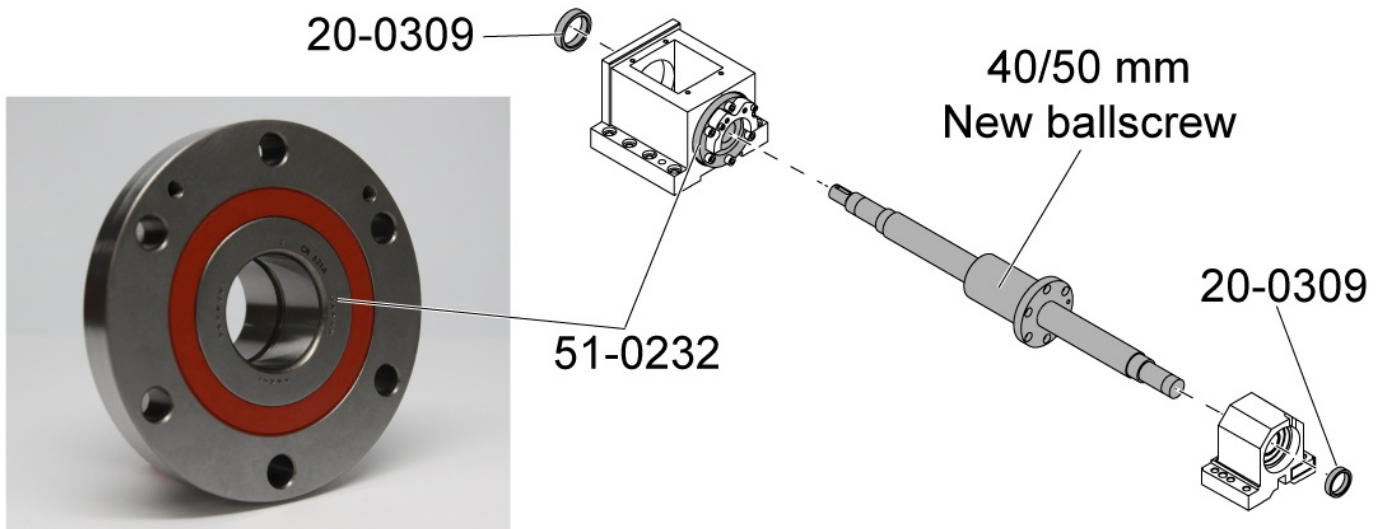

- P/N 51-0232 has a machined steel finish.
- Install spacer P/N 20-0309 in the same position on the motor end.
- Do not install the spacer P/N 51-0241 when you install a new 40/50 mm ballscrew into bearing P/N 51-0232.
- The support end has only (1) spacer P/N 20-0309.

slide\_content

## 40/50 mm Ballscrew - Reverse Anchor - Bearing - Identification

When you install a new 40/50 mm ballscrew into bearing P/N 51-0232 you must install a spacer. Refer to these images to identify the installed bearing.

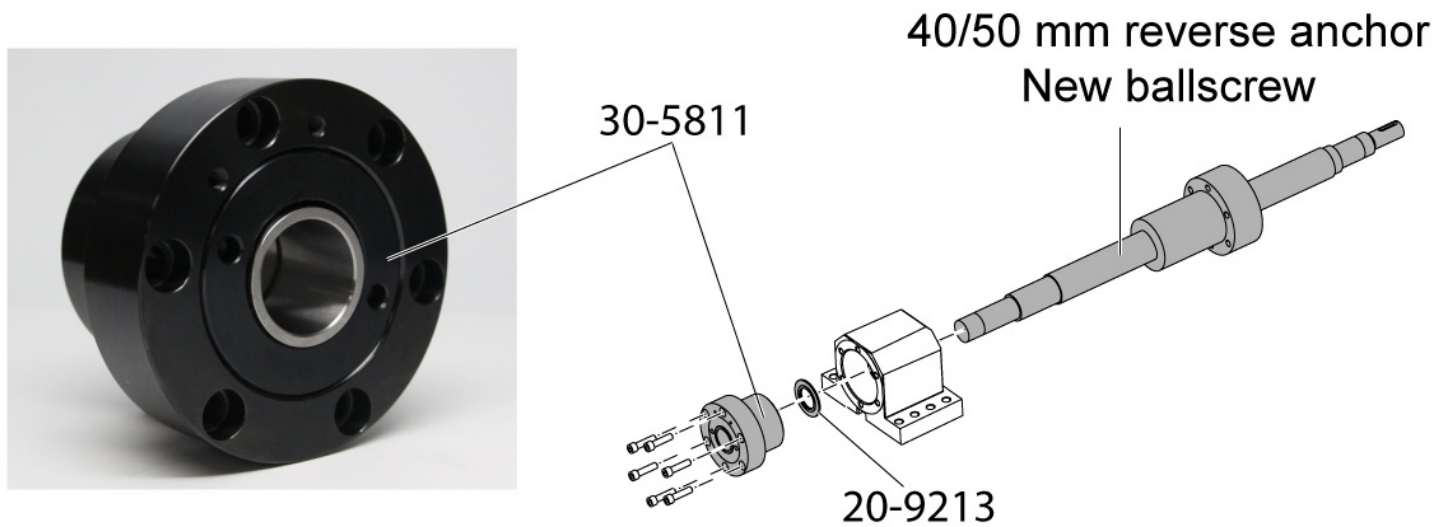

- P/N 30-5811 has a black oxide finish.
- Install spacer P/N 20-9213 in the same position on the support end.



**Note:** You do not have to remove the bearing to install the ballscrew.

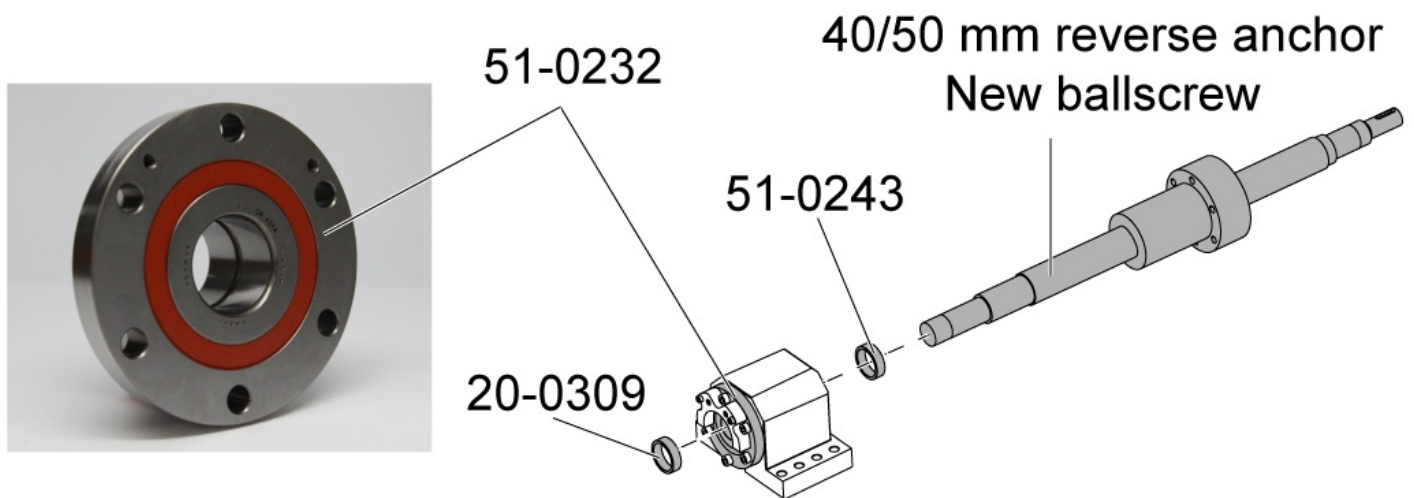

- P/N 51-0232 has a machined steel finish.
- Install spacer P/N 20-0309 in the same position on the support end.
- Install spacer P/N 51-0243 in the same position when you install a new 40/50 mm ballscrew into bearing P/N 51-0232.

slide\_content

## 50 mm Large Ballscrew - Standard Anchor - Bearing - Identification

When you install a new 50 mm large ballscrew into bearing P/N 51-10067 you must install a spacer. Refer to these images to identify the installed bearing.

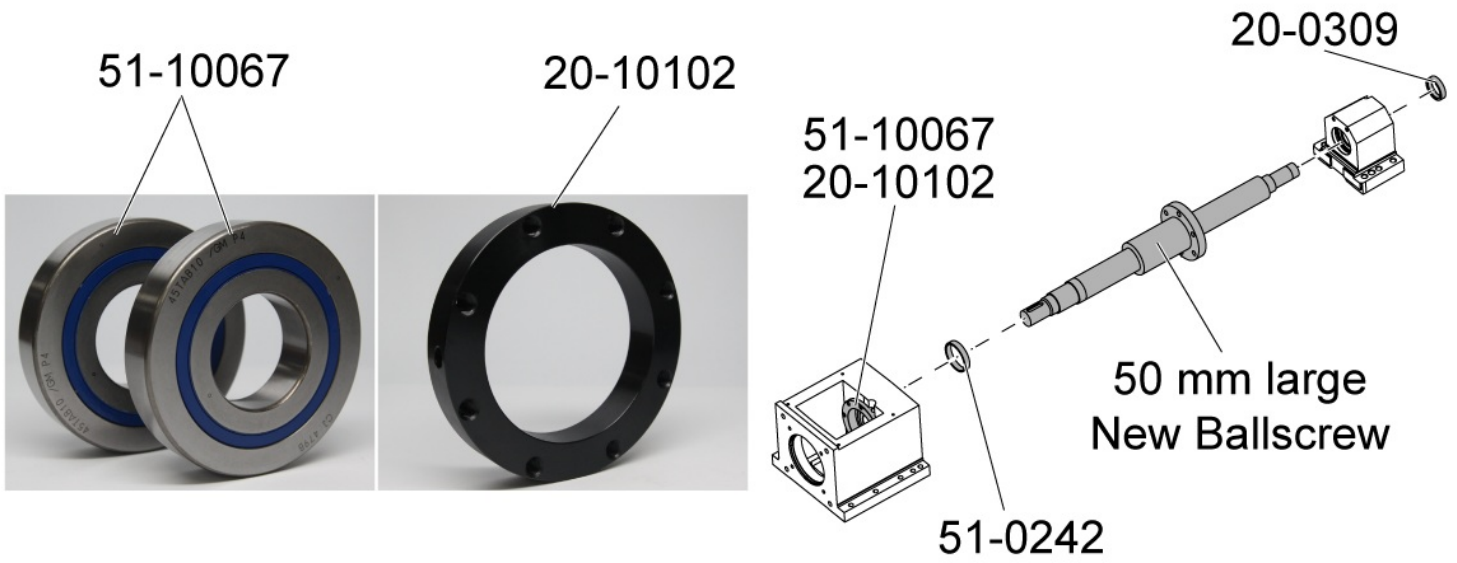

- The bearing assembly has P/N 20-10102 that has a black oxide finish and (2) P/N 51-10067 bearings.
- Install only (1) of the spacers P/N 20-0309 on the support end.
- Install spacer P/N 51-0242 when you install a new 50 mm large ballscrew into a bearing assembly that has P/N 20-10102 and (2) P/N 51-10067 bearings.

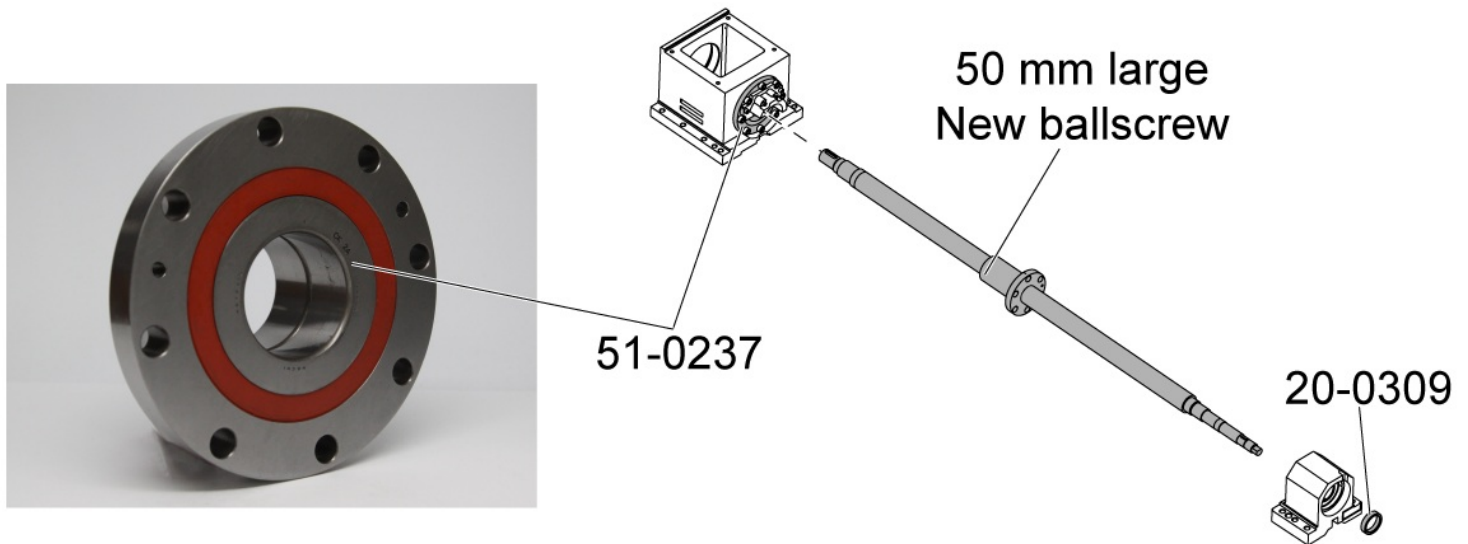

- P/N 51-0237 has a machined steel finish.
- The support end has only (1) spacer P/N 20-0309.
- Do not install spacer P/N 51-0242 when you install a new 50 mm large ballscrew into bearing P/N 51-0237.