

ITEM NO.	DESCRIPTION	QTY.
1	PLATE SPRING ENCDR MOUNT S30 BB	1
2	HAAS MAGNETIC ENCODER (SHAFTED)	1
3	TIMING PULLEY .375 BORE	1
4	SSS 8-32 X 1/4 HALF DOG	1
5	SPRING EXT .29 OD X 1.5 LENCODER BELT TE	2
6	ENCODER SPRING MOUNT 50T GEARBOX 50/BX	1
7	CLAMP ENCODER SPRING MNT INLINE/SL-20	1
8	SPINDLE MOTOR 20HP LNC MAG ENC	1
9	PULLEY DRIVE HTD 3MX09 P36-3M-09 0.75	1
10	OIL MIST NOZZLE DOUBLE 5.35	1
11	NUT 1/2-13 JAM	1
12	FITG LBO-1/4 X NPT-1/8-M X 90 AIR ONLY	2
13	RING RETAINER SPINDLE	1
14	SPKT GT 8M-72-60	1
15	O-RING 2-265 BUNA	1
16	SHCS 3/8-16 X 1 1/4	6
17	SPINDLE CARTRIDGE	1
18	CHUCK CYL 10 M85 BODY KTA	1
19	DRAWTUBE	1
20	HS CHUCK CLOSER ADAPTER, S30	1
21	GASKET COOLANT COLLECTOR HOUSING SL-20/3	1
22	CLNT COLL SEAL	1
23	CLNT COLL ADPTR SAM/KTA 10"	1
24	CLNT SEAL ADPTR ST30	1
25	DRV BELT HTD 3MX09 384-3M-09	1
26	DRV BELT 1440-8MGT-20 SET OF 3	1
27	COVER SPNDL MTR BOTTOM ST30	1
28	25-11579E COVER SPNDL MTR NO TRANS ST30	1
29	FRONT MTR CVR NO TRANS	1
30	COOLANT COLLECTOR, S30	1
31	MOTOR ENCDR STAND OFF	2
32	UPPER BELT SHROUD ST30	1
33	UPPER BELT SHROUD BOTTOM	1
34	LOWER BELT COVER	1
35	HYD CLSR ANTI ROT BRKT S	1
36	FITG REDUCER NPT-1-M X NPT-3/4-F	1
37	HOSE CLAMP	1
38	CLNT DRAIN FITTING	1
39	FAN 10 600CFM	1

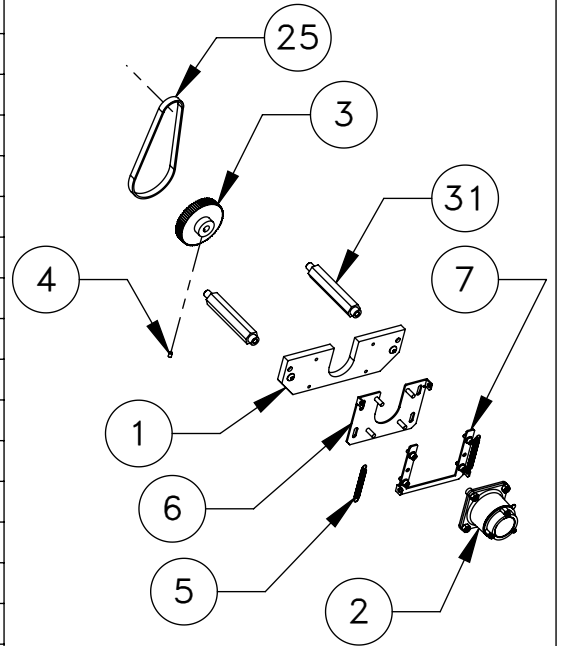

DETAIL A  
SCALE 1 : 10

DESCRIPTION	EFFECTIVE DATE
ST-30 SPINDLE HEAD ASSY 3400 RPM BELT	FEB-2013