

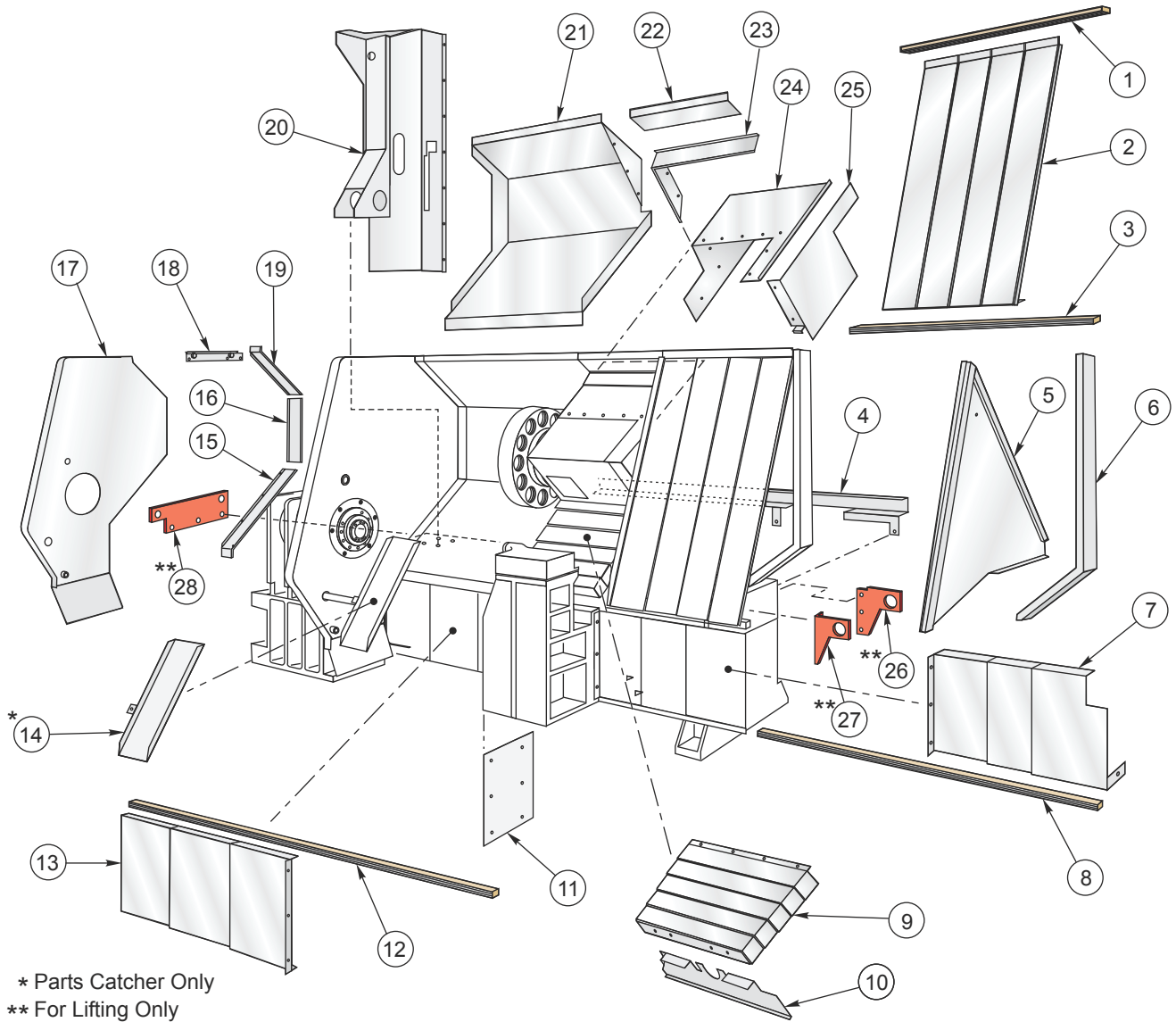

SL-20 - Internal Enclosure



1. Upper Waycover Guide (SL-20)
Upper Waycover Guide (SL-20L)
2. Z-Axis Waycovers (SL-20)
Z-Axis Waycovers (SL-20L)
3. Lower Waycover Guide (SL-20)
Lower Waycover Guide (SL-20L)
4. Cable Rail
5. Moving Bulkhead (SL-20)
Moving Bulkhead (SL-20L)
6. Right Support
7. Tailstock Right Waycovers (SL-20)
Tailstock Right Base Cover (SL-20L)
8. Lower Tailstock Waycover Guide (SL-20 only)
9. Tool Changer Waycover
10. Front Wedge Cover (SL-20)
Front Wedge Cover (SL-20L)
11. Tailstock Cover
12. Upper Tailstock Waycover Guide (SL-20 only)
13. Left Tailstock Waycovers (SL-20)
Tailstock Left Base Cover (SL-20L)
14. Parts Catcher Tray (Optional)
15. Z-Axis Bottom Wiper (SL-20)
Z-Axis Bottom Wiper (SL-20L)
16. Z-Axis Back Wiper (SL-20)
Z-Axis Back Wiper (SL-20L)
17. Fixed Bulkhead (SL-20)
Fixed Bulkhead (SL-20L)
18. Upper Door Wiper Assembly
19. Z-Axis Top Wiper (SL-20)
Z-Axis Top Wiper (SL-20L)
20. Control Box Mounting Bracket
21. Rear Sliding Cover (SL-20)
Rear Sliding Cover (SL-20L)
22. Tool Changer Tunnel Panel
23. X-Axis Wiper
24. Tool Changer Sliding Cover
25. Tool Changer Splash Shield
26. Right Rear Lifting Bracket
27. Right Front Lifting Bracket
28. Left End Lifting Bracket