

Go to parts.haascnc.com to get pricing and installation instructions for selected parts.

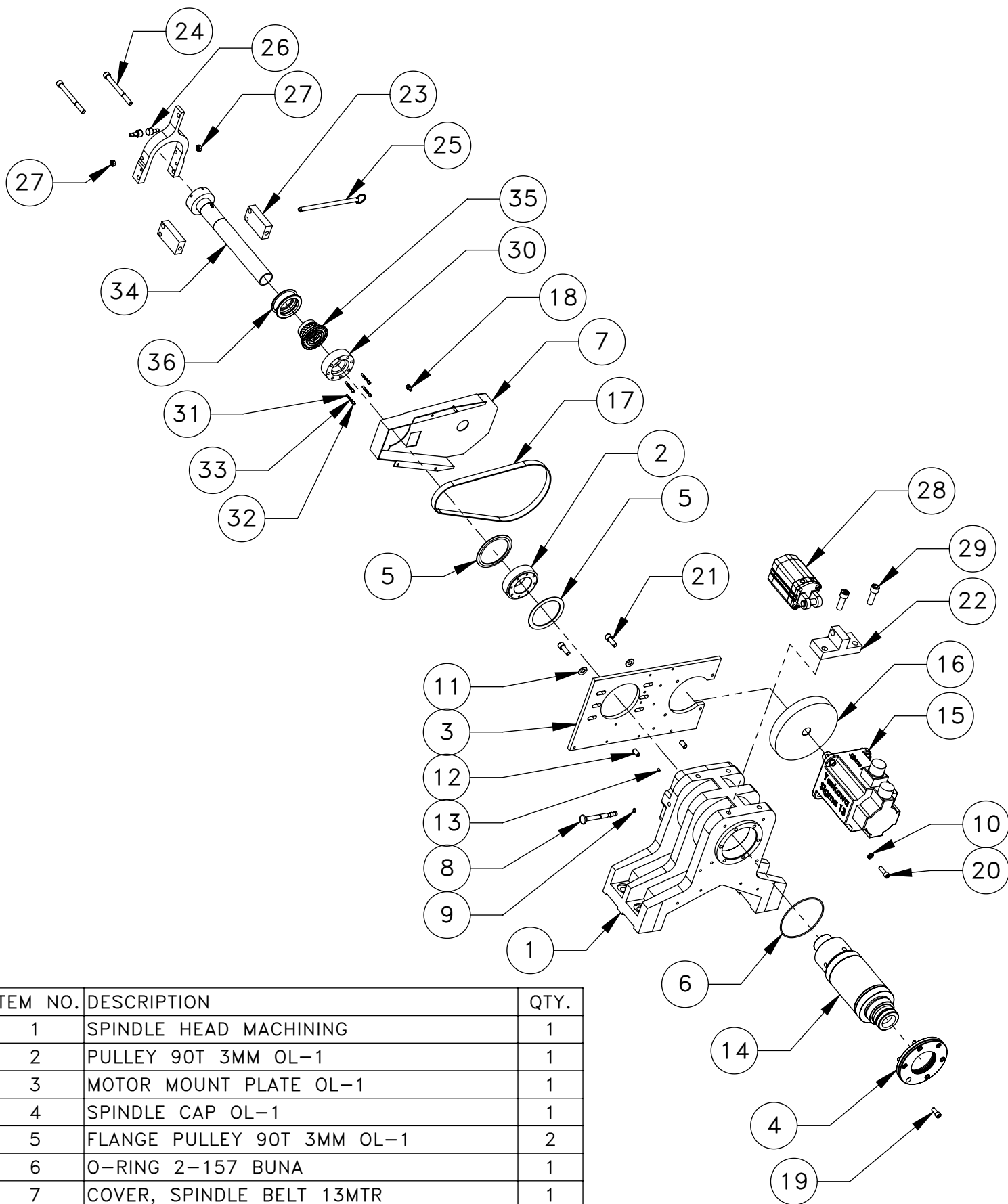

ITEM NO.	DESCRIPTION	QTY.
1	SPINDLE HEAD MACHINING	1
2	PULLEY 90T 3MM OL-1	1
3	MOTOR MOUNT PLATE OL-1	1
4	SPINDLE CAP OL-1	1
5	FLANGE PULLEY 90T 3MM OL-1	2
6	O-RING 2-157 BUNA	1
7	COVER, SPINDLE BELT 13MTR	1
8	SPINDLE STOP PIN HPCL	1
9	O-RING 2-010 BUNA	1
10	WASHER 5/16 SPLT LOCK PLT	4
11	WASHER 3/8 HARD #275-15	2
12	DOWEL PIN 3/8 X 3/4	2
13	SSS 10-32 X 1/4 CUP PT	1
14	SPACER SET 60MM OL-1	1
15	SRVOMTR YASK 13 NO BRK (SB 340)	1
16	PULLEY 180T 3MM -13 MTR	1
17	DRV BELT PGGT3MR-840 15MM OL-1	1
18	SHCS 10-32 X 3/8 W/ FLAT WASHER	4
19	SHCS 5/16-18 X 3/4	6
20	SHCS 5/16-18 X 1	4
21	SHCS 3/8-16 X 1	2
22	CYLINDER MOUNT AAC OL-1 EXT TRAVEL	1
23	LEVER MOUNT	2
24	SHCS 3/8-16 X 1 3/4	2
25	PIN QUICK RELEASE 3/8X6	1
26	TRACK ROLLER O.S. 5/16 STUD	2
27	NUT 5/16-24 HEX	2
28	AIR CYLINDER, ACC OL-1 W/INT BU	1
29	SHCS 1/2-13 X 1 1/2	2
30	DRAWBAR BUSHING AAC OL-1	1
31	DETENT PIN S5C	4
32	SSS 1/4-28 X 1/4 FLAT PT	4
33	SPRING DETENT COMPRESSION SPRING	4
34	DRAWBAR AAC OL-1	1
35	DETENT RING S5C	1
36	LOCKING COLLAR AAC OL-1	1

SHEET 1 OF 1

DESCRIPTION
OL-SPINDLE HEAD ASSY

EFFECTIVE DATE
JUNE-2005

SAP DOC NO./VER: 1000007575/01